

Universal



Universal B



Universal B/2M

UNIVERSAL

AUTOMATION FOR ROLLING SHUTTERS

Suitable for residential and industrial areas.

Suitable for existing or brand new shutters. Built-in limit switches, to ensure easier safe regulation in opening and closing. Available in reversible or locked version, featuring electro-break and release system for manual operation.

Transmission gear accessories and spring pulley adapters included.

For big shutters dual-motor operator available.

OPTIONAL



MYRT_
wireless keypad



RT23_
safe box with
release lever



Q45
230V
control unit



MYRS_
key switch



MYRL_
flashing light



MYRF_
safety photocells set

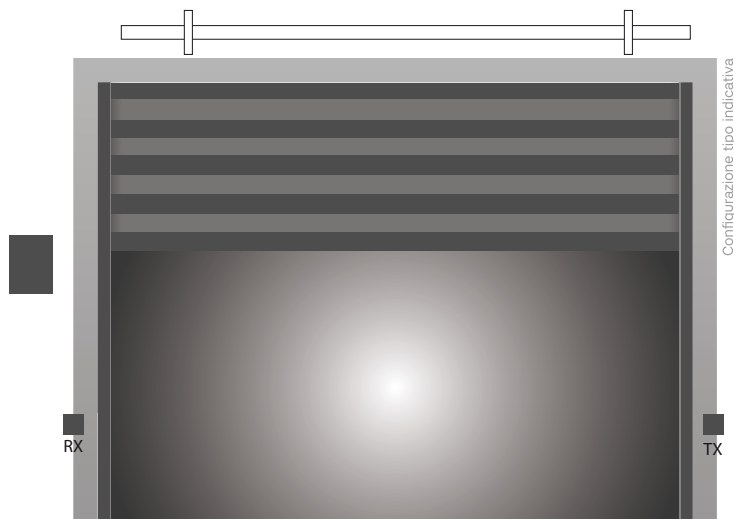

DIMENSIONS

200 mm Universal B
240 mm Universal B/2M

60



385 mm Universal B
400 mm Universal B/2M

320 mm Universal

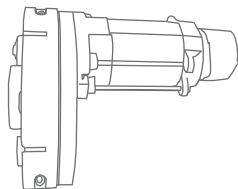

years of
warranty **3**

TECHNICAL DATA

Power supply
Current
Motor power
Thrust
Pulley speed
Max load
Max stroke
Drive-shaft diameter
Spring-holder pulley
Duty Cycle

V
A
W
Nm
rpm
Kg
m
mm
mm
%

	UNIVERSAL	UNIVERSAL B	UNIVERSAL 2M
Power supply	230V~50/60Hz	230V~50/60Hz	230V~50/60Hz
Current	2.7	2.7	5.5
Motor power	600	600	1260
Thrust	178	178	443
Pulley speed	10	10	8
Max load	170	170	360
Max stroke	6	6	6
Drive-shaft diameter	60/48	60/48	76
Spring-holder pulley	200/220	200/220	240
Duty Cycle	30	30	30