

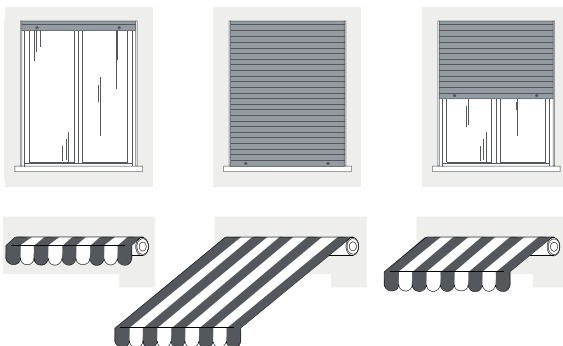

PTP45

Automation for blinds and awnings Installation manual



PTP45 20 - PTP45 30 - PTP45 50



PTP45 50M

Index

1.	SAFETY INSTRUCTIONS	p.	01
2.	DESCRIPTION AND INTENDED USE	p.	02
2.1	Technical data	p.	02
2.2	Selection guide	p.	02
2.3	Kit content	p.	03
2.4	Dimensions	p.	03
3.	INSTALLATION	p.	04
3.1	Wiring	p.	06
3.2	Limit switch setting	p.	06
3.2.1	Limit switch in closing	p.	06
3.2.2	Limit switch in opening	p.	07
3.3	Awnings	p.	07
4.	WARRANTY	p.	08
5.	MAINTENANCE	p.	08
6.	DISPOSAL	p.	08
7.	ERROR MESSAGES	p.	08
8.	COMPLIANCE DECLARATION	p.	08

1. SAFETY INSTRUCTIONS

WARNING

This manual contains important information concerning personal safety: children aged 8 or more and/or people with reduced physical, sensory or psychic abilities are allowed to use the automation if under supervision or duly instructed on possible risks and danger.

Children are forbidden to play with the automation.

Maintenance and cleaning may be performed by children only under supervision. Frequently check possible sign of waste and damage (wires and supports).

Do not use the automation if repairing is needed or if maintenance is in progress (ex: windows cleaning).

Important safety instructions for people, READ CAREFULLY when you see this symbol: 

 **Installation has to be powered through an all-pole disconnection switch**

 **Switch the power OFF before any operation.**

 **Before proceeding to installation, remove any useless wires and/or components. The characteristics of the area to be automated have to match the automation capacity in terms of load and working time.**

 **Make sure the main power line is equipped with state of the art safety ground system. If the power line wire is wasted inform the Manufacturer or contact an authorized service center for replacement.**

Use and installation of the product must comply with Machinery Directive 2006/42/CE. Installation must be carried out by expert qualified personnel who knows the potential hazards associated and in full compliance with current regulations. Use of the product must be restricted to its intended use. Any other use is to be considered dangerous and therefore forbidden.

 **Keep any remote control device (i.e. transmitters) away from children, to prevent the automation from being accidentally activated.**

Keep the automation regularly maintained. Use only Proteco's original spares. Users are strictly forbidden to carry out any changes on the system. Proteco Cancelli Automatici Srl is not liable for any damage resulting from improper, wrongful or unreasonable use.

2. DESCRIPTION AND INTENDED USE

The PTP45 range is designed to automate blinds and awnings.

2.1 TECHNICAL FEATURES

		PTP4520	PTP4530	PTP4550	PTP4550M
Thrust	Nm	20	30	50	50
Motor Speed	rpm	17	17	13	13
Motor Power	W	155	226	244	244
Current	A	0,68	0,95	1,06	1,06
Weight	Kg	2,30	2,35	2,40	3,30
Length	mm	440	480	480	620
Noise level			LpA ≤ 70 dB(A)		

2.2 SELECTION GUIDE



Surface calculation:
 $\text{height} \times \text{width} = \text{m}^2$
 select the model according to
 the table below

MATERIAL		MAX m ²							
		2.5	3.5	4	5.25	7	8	9.5	15
PVC and light Aluminium	6Kg/m ²	PTP45 20			PTP45 30		PTP45 50		
Extruded Aluminium and Steel	9,5Kg/m ²	PTP 45 20		PTP45 30		PTP45 50		N.A.	
Wood and armored Steel	12,5Kg/m ²	PTP45 20	PTP45 30		PTP45 50		N.A.		

Model	Nm	Max Lifting
PTP45 20	20	32 Kg
PTP45 30	30	52 Kg
PTP45 50 PTP45 50M	50	90 Kg



Ø70 mm tubular motors
 Intersect the value of the extension
 with the number of arms of the awning

		N° ARMS		
		2	4	6
EXTENSION OF ARMS	4	PTP45 50 PTP45 50M	PTP45 50 PTP45 50M	PTP45 50 PTP45 50M
	2,5	PTP45 30	PTP45 50 PTP45 50M	PTP45 50 PTP45 50M
	1,5	PTP45 30	PTP45 50 PTP45 50M	PTP45 50 PTP45 50M

2.3 KIT CONTENT

PTP 45 (without emergency release)



- 01 n°1 Tubular motor
- 02 n°1 Limit switch adjuster wrench
- 03 n°1 Split pin
- 04 n°1 Wall fixing support

PTP 45 M (with emergency release)

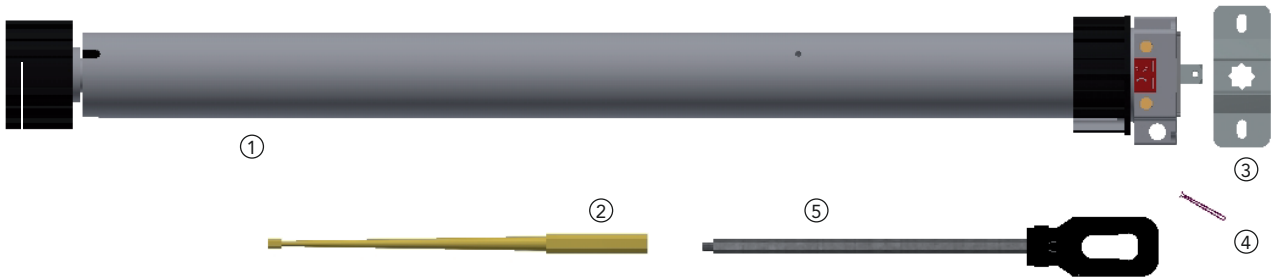

- 01 n°1 Tubular motor
- 02 n°1 Limit switch adjuster wrench
- 03 n°1 Wall fixing support
- 04 n°1 Split pin
- 05 n°1 Release key

2.4 DIMENSIONS

PTP45 20 – PTP45 30 – PTP45 50

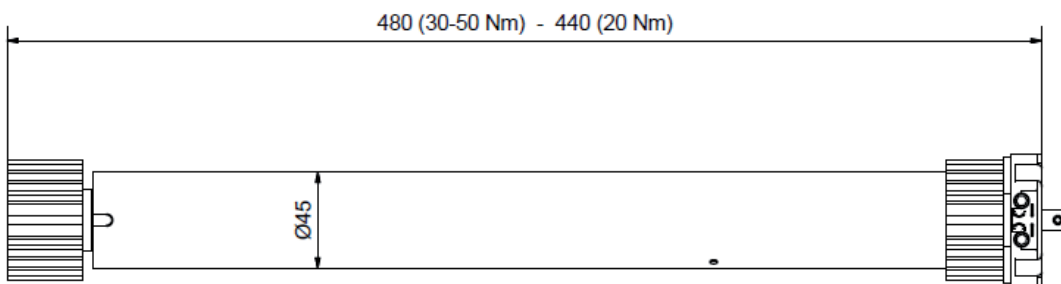

PTP45 50M

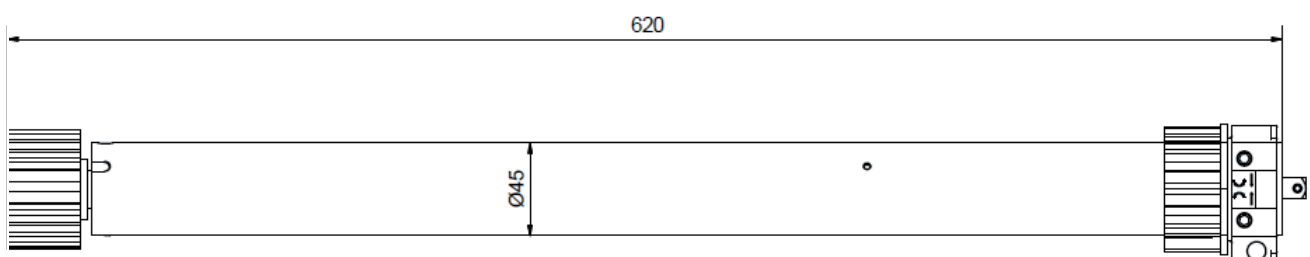

3. INSTALLATION

Before installing make sure the power supply is OFF. If you need to replace an existing system, remove all devices for manual operation.



Make sure the command keys are positioned where the system can be visible during operation and at a minimum ground height of 1,5m.



Make sure manual operation devices are positioned at least at a minimum ground height of 1,8 m.

In case of an existing system, it is possible to keep the same octagonal adapter 60mm.

- 1- Low down the roller blind and disconnect it from the octagonal tubular (Picture A).
- 2- Remove the octagonal tubular (Picture B).

Picture A



Picture B



RECOMMENDED TOOLS:

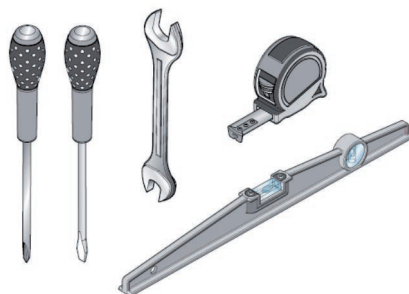

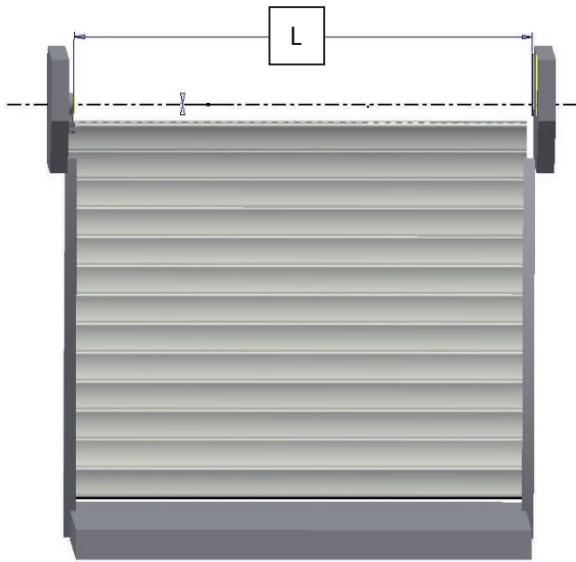

3 - Measure the distance between the two supports (L). Fit the 60 mm octagonal tubular in for the whole length till covering the locking ring of the limit switch (Picture C).

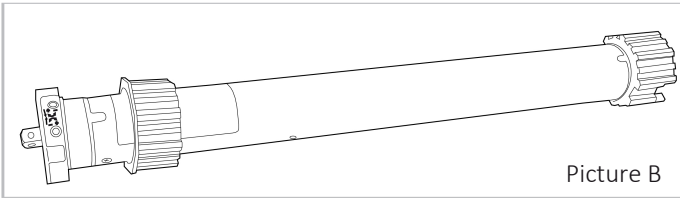

Picture B



Picture C

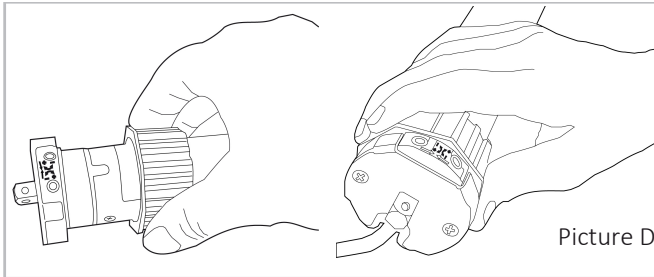

Picture D

4- The length of the octagonal tubular must be such to get the total length (L) as shown in the below picture, keeping a clearance of 2-3 mm. In order to check the correct position and to simulate the final installation, lay temporarily the support to the wall as shown in the picture.

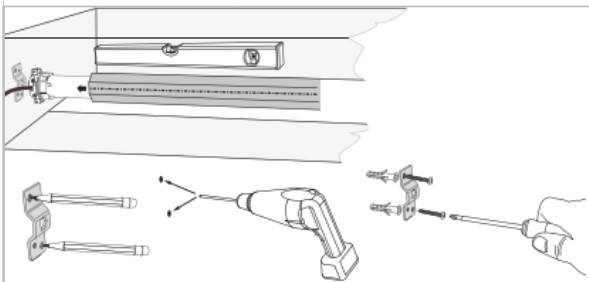
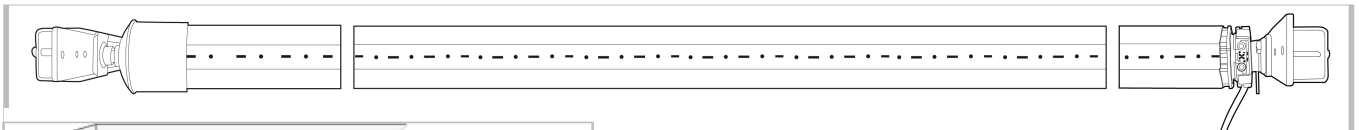

5- Simulate the preassembled automation, respecting the alignment between the two fixing supports and check that the octagonal tubular is on level. Mark the holes of the fixing support in a way to get easy access to both fixing screws. Proceed to fix the support to wall.

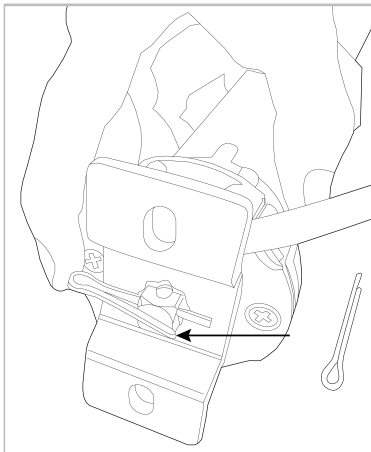

6- Complete the assembling locking the system with the provided split pin.



Attention! During manual operation we recommend to keep the limit switch screws in downward position.

3.1 WIRING

Wire the system according to the below diagram:

To be up to safety standards we recommend to fit a power cut device, keeping a minimum distance of 3 mm between the contacts. Every motor has to have its own device.

- WIRES KEY:**
- 1 BLACK
 - 2 BROWN
 - 3 BLUE(Common)
 - 4 YELLOW/GREEN

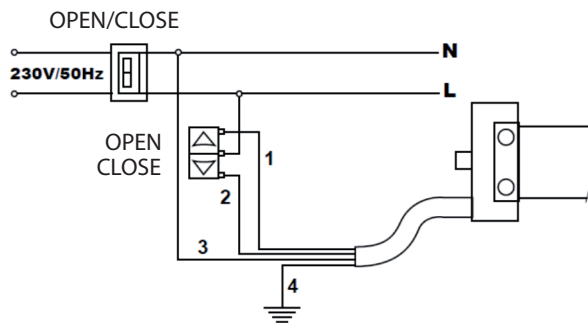

Wiring diagram for motor installed at your left

If you wish to install the motor at your right, just switch the black wire with the brown.

It's always wise to double check the wiring: if the rotation should not proper, just switch the position between the black and the brown wires.

3.2 LIMIT SWITCH SETTING

3.2.1 LIMIT SWITCH IN CLOSING

Before fitting the store/awning make sure the motor is properly mounted inside the octagonal tubular as well as the limit switch trolley. Now let the motor run down till reaching the expected end stop position activated by the limit switch. Then fit the store to the octagonal tubular.

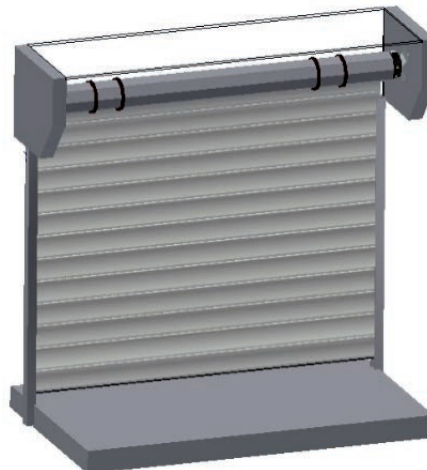
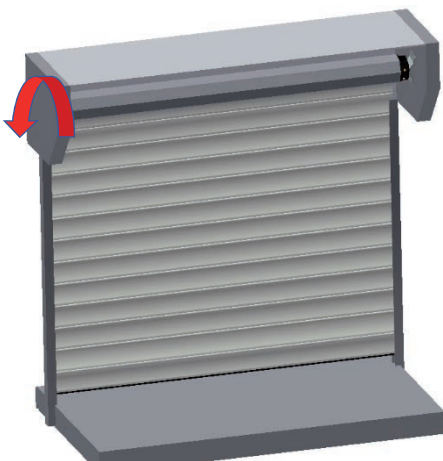

3.2.2 LIMIT SWITCH IN OPENING

Give an opening command. Check the store operation and make the according adjustments if necessary. To set the limit switch, plug the provided key into the according fixing points. If you wish to increase the run of the store/awning, turn to "+", while if you wish to decrease it turn to "-". The below diagrams show how to adjust the available systems, opening setting (possible adjustments for RH and LH motor):

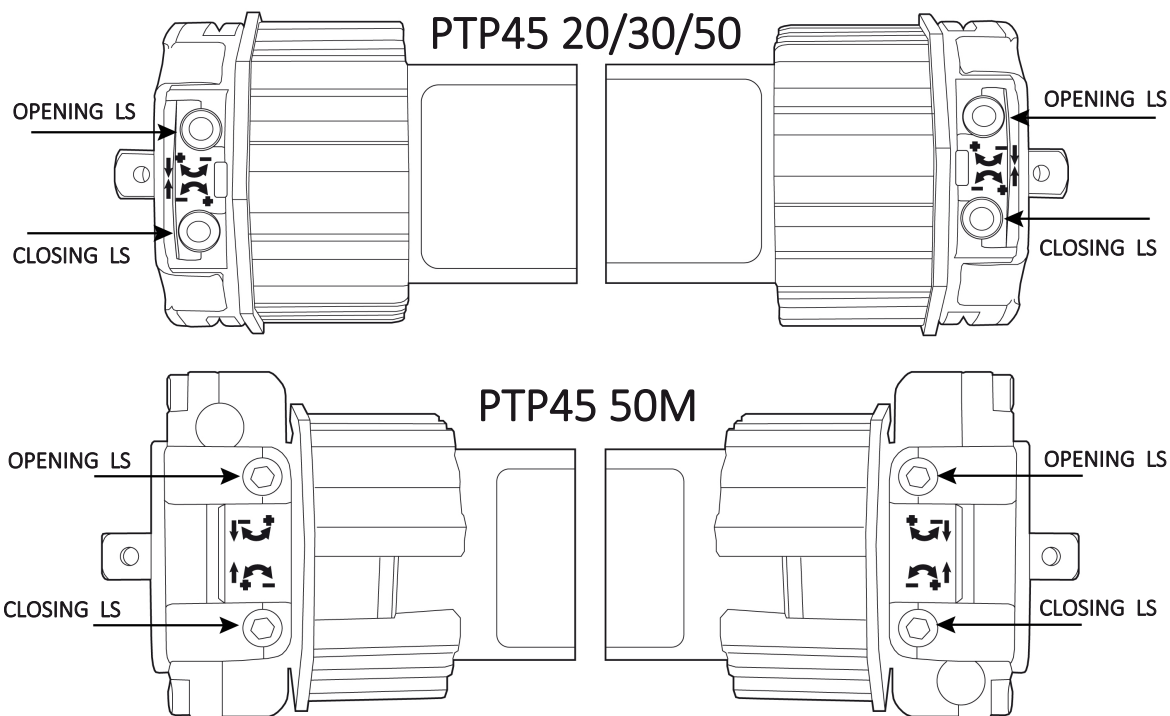

3.3 AWNINGS

Ø 70 adapters are available for awnings. Item code PTPRO1W.
So far the assembly attend the awning manufacturer's instructions.
So far the wiring and limit switch adjustment refer to the store installation manual.

4. WARRANTY

PROTECO Srl is liable for any manufacture fault on tubular motors, electrical components and accessories during 3 years from manufacture date.
PROTECO Srl responds for repairing within the warranty terms, after inspection by its technical staff. The returned faulty system will remain a Proteco's property.
Use of the product must be restricted to its intended use. Any other use shall be considered out of the warranty.
Installation and maintenance are charged at the person who carries out the installation.
Use only Proteco's original spares. Users are strictly forbidden to carry out any changes on the system.
PROTECO Srl is not liable for any damage resulting from improper, wrongful or unreasonable use.
The return costs are at customer's charge.

PROTECO Srl Via Neive 77, 12050 Castagnito (CN) Italia

The warranty doesn't respond when:

- The chosen system doesn't comply with the features of the store or awning
- Prescriptions contained into the installation manual are disrespected
- The item has been used/stored in unproper conditions
- The item has been repaired, modified, altered
- The item has been wrongly used or neglected
- The manufacture label is damaged or is missing
- The bad operation is due to oxidation, overvoltage, insects, animals

5. MAINTENANCE

Functional checks must be performed once every 6 months, including: checking the state of lubrication and tightness of the anchoring screws on the operator as well as the good operation of all safety devices.

6. DISPOSAL



DO NOT DISPOSE OF IN NATURE!

Some components may contain hazardous waste.

They must, thus, be removed and turned into licensed firms for their disposal.

7. ERROR MESSAGES

FAULT	SOLUTION
THE MOTOR DOESN'T WORK	• Double check the motor's wiring
	• Double check the motor doesn't overheat
THE MOTOR STOPS BEFORE THAN EXPECTED	• Double check the limit switch operation during motor's running
	• Double check the limit switches work properly
THE MOTOR DOESN'T STOP	• Double check the limit switch crown has been correctly inserted into the motor

CE COMPLIANCE DECLARATION

Manufacturer: PROTECO S.r.l.

Address: Via Neive, 77 – 12050 Castagnito (CN) – ITALIA

Declares that:

Product type: Electromechanical tubular motor PTP45 for blinds, awnings and according

Models: accessories corresponding to PTP45 20, PTP45 30, PTP45 50, PTP45 50M

It complies with the essential requirements of the EU Directives:

2006/95/CE **Low Voltage Directive**

2004/108/CE **Electromagnetic Compatibility Directive**

It also complies, limited to the applicable parts, with the following standards:

EN 55014-1

EN 55014-2

EN 60335-1: 2002+A1+A11+A12+A2+A13

EN 60335-2-97:2006+A11

EN 61000-3-2

EN 61000-3-3

We also declare that the machine is not allowed to be put into service until the machine has been identified and declared compliant with the

Machinery Directive 2006/42/EC.

Castagnito, October 1st 2015

Marco Gallo
CEO